

Operation Instruction

User's Manual



Contents

Chapter 1: Machine System Description

1.1 Introduce for Machine

1.2 Working Principle

Chapter 2: Safety Attentions

2.1 Electrical Safety

2.2 Transportation Safety

2.3 Primary Warning

Chapter 3: Structure And Description

3.1 System Construction

3.2 Control Panel

3.3 Releasing Water

3.4 Adapter description

Chapter4: Installation

4.1 Electrical Requirement

4.2 List Of Equipment

4.3 Installation Process

Chapter: Operation

5.1 Interface Description

5.2 Quickly Access

5.3 Machine Parameter

5.4 Machine Operation

Chapter1 Machine System Description

Thank you so much for purchasing our machine ! Please believe this machine will bring you reliable service and good performance
This chapter is a general description for this machine
Attention: People who operate or maintenance this machine must read the manual carefully before operation

1.1 Machine Description

Cooling machine is a incredible cooling system, which will never disturb the laser output and working. Combine with the laser equipment, such as 808 diode laser, IPL, RF, To relieve patient' s pain, redness, swelling and hear damage.

1.2 Working Theory

Before operation using, have a temporary anesthesia.

Powerful cooling to -20°C 。

The 1500W high-power compressor provided by Danfoss ensures the system can work continuously for long periods of time. (When the wind speed level is 4, The machine can work for 2 hours the minimum temperature)

High-speed fans have a strong cooling effect, also 6 levels wind speed can meet the needs of different treatments.

Automatic defrost is the best performance for cooling.

The self-draining system ensures the safe and cleaning of machine.

The supporter for cooling make the operation more comfortable.

Chapter 2 Safety Attention

2.1 Electrical Safety

To ensure the safety, this machine' s design and producing strictly following the: 《**General requirements for safety of medical electrical equipment**》 to producing and test.

The operating system uses single-phase 220V (50Hz) power supply, the maximum input shouldn' t larger than 3A, 110 volts (60Hz) the maximum input current shouldn' t larger than 4A. In order to ensure the stable of performance, If your voltage is not stable, which will influence the machine, you need to have a 1500W regulator.

Notice: The operating system of the power supply with a standard three-core national standard connector to ensure that your network power outlet with a protective grounding wire, and safe grounding.

2.2 Transportation Safety

This machine is a mechanical, electronic 2 in 1 machine, which not allow users to use the long distance bumps. During the transport process, you must use the original shock absorber package, otherwise it may lead to damage for the refrigeration system and mechanical, electronic damage. In that case, our company will not bear any

responsibility.

2.3 Primary Warning

- Non-professionals do not enter the treatment room
- Ensure all the people are familiar for the operation
- Not use this system in places where flammable or explosive or other insecurity is present
- Make sure that the safety warning card is in a obvious position when using this system

Chapter 3: Construction and Description For machine

3.1 System Build Up

Front View

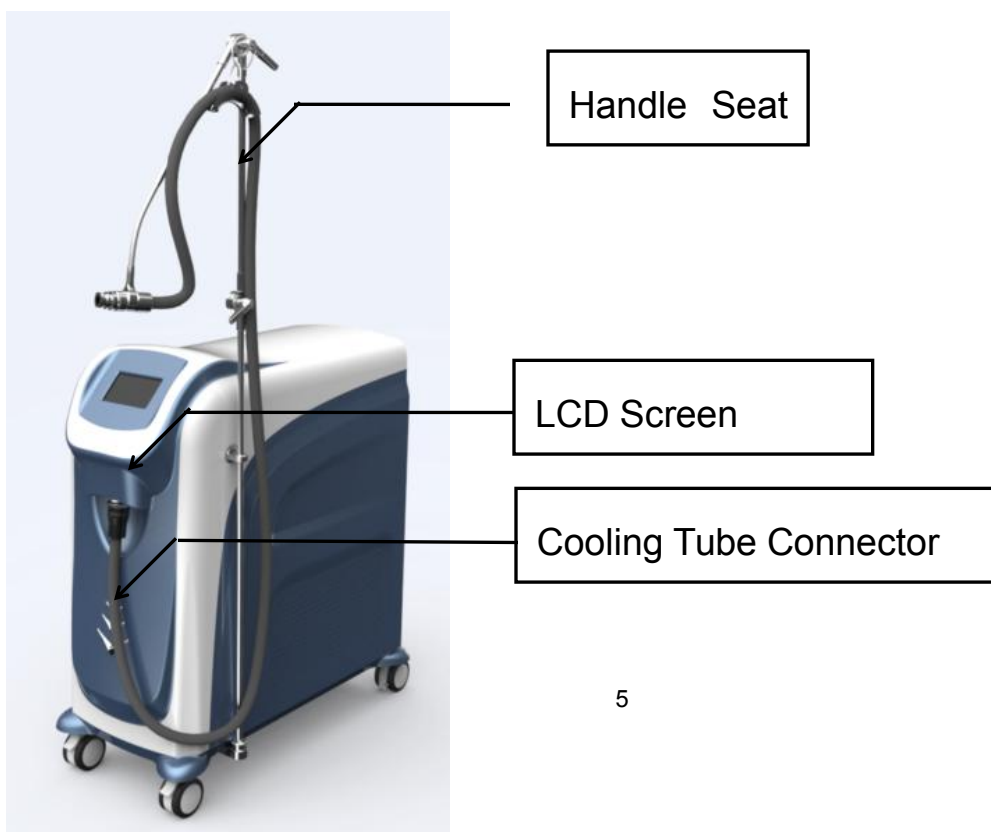

Back View

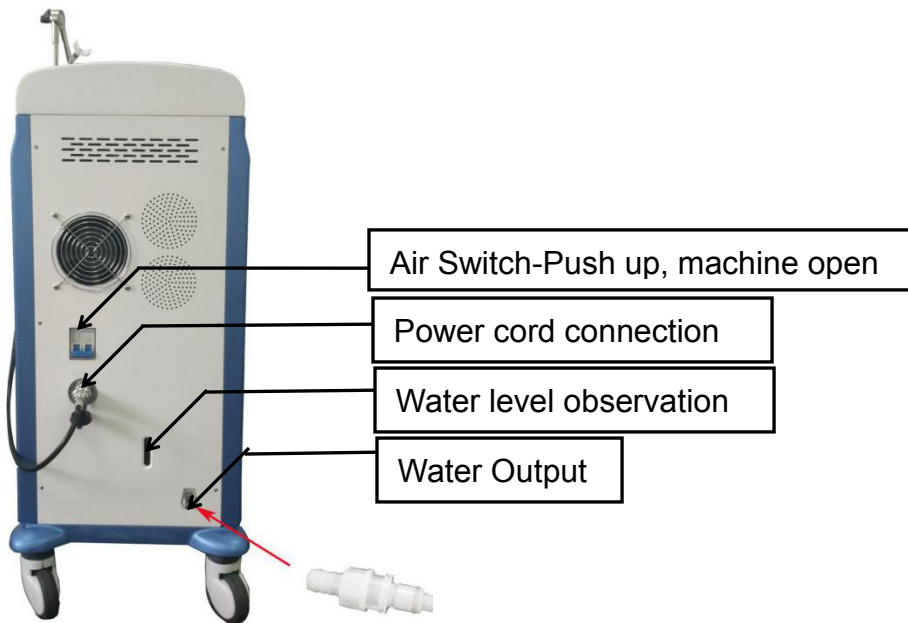

Cooling Tube



Treatment Head



Cooling Tube Supporter

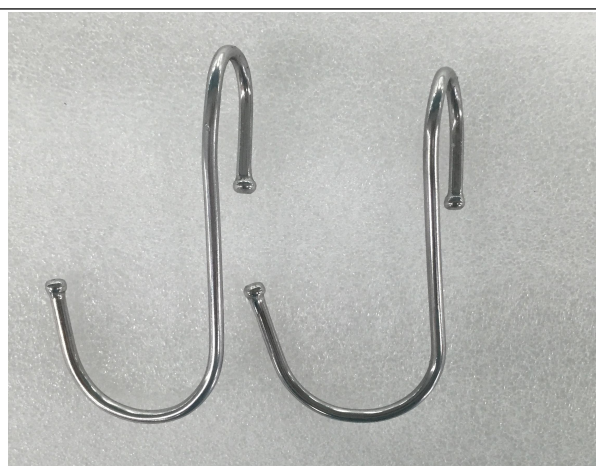

Bracket Clip

3.2 Control Panel

Push the Air Switch the machine is start, from original interface into the operation interface, More detail please see the photo 5.1.

3.3 Drain Water

The machine need to do the defrost after 2 hours working, The machine tank stores the water produced by the defrost process. Through the water level observation to observe the water level inside the tank, do the water drainage after water tank is full .

3.4 Adapter Instruction

Name	Image	Function Description
Round Adapter		Small range treatment, reduces skin temperature, such as eyebrows, armpits, foreheads
Middle square Adapter		Moderate range of treatment to reduce skin temperature, especially hair removal treatment, such as arms, armpits, legs
Large square Adapter		Large-scale treatment reduces skin temperature, especially hair removal treatment, such as thighs and abdomen
808 Adaptor Head (Optional)		With 808 laser hair removal treatment
SHR Adaptor Head (Optional)		With IPL, SHR hair removal, rejuvenation treatment

Chapter 4: Installation

4.1 The corresponding electrical requirements of the equipment

The machine can be installed in the hospital, medical clinics and beauty salon. The preparation of the preparation before the very little, when you buy my company's equipment, you can get my company's free installation training guide.

The instrument should be authorized by our company's professional and technical personnel installation and commissioning familiar with the installation requirements:

Before opening the instrument, check that the installation environment location meets the requirements described in this section.

The system should be installed away from the hot air, and with other objects have a certain distance.

The instrument in accordance with the requirements of the factory before the installation of the location of the installation of the rated voltage. The corresponding electrical requirements for the equipment are as follows:

- ◆ Single-Phase 220V \pm 10%, 10A 50Hz
- ◆ The grounding of the equipment through the wall of the power jacket is grounded by the wall line. Good grounding is essential for safe operation.
- ◆ The input voltage can not have transients, voltage and current spikes, collapses or surges.
- ◆ To ensure that the system is in the best condition, the indoor temperature should be kept at about 20 °C, the relative humidity can not exceed 80%, therefore, the treatment room is best equipped with air conditioning.
- ◆ Do not allow the instrument to be exposed to direct sunlight for long periods of time.

4.2 Equipment List

- (1) **One machine**
- (2) **One Power Cord**
- (3) **One cooling Tube**
- (4) **3 Treatment heads**
- (5) **One Set Cooling tube Supporter**

(6) 2 Supporter Clip

(7) One set CPC and 50CM silicone tube

(8) Acrylic board(second generation)

(9) 4 Crews (Second Generation)

4.3 Installation Process

Step 1: Open the box, remove the machine parts, open the package;

Step 2: Insert the bracket into the fixed point as shown;

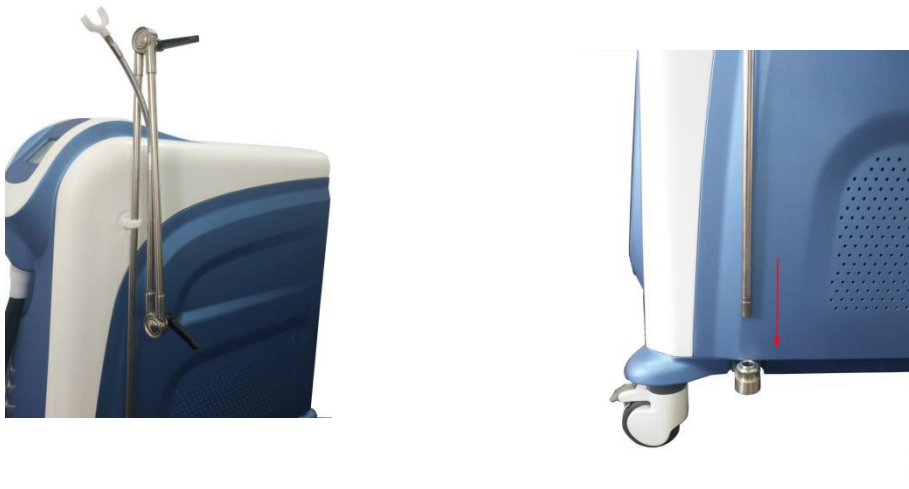

Step 3: After loosening the black knob, adjust the bracket and fix the black knob



Chapter 5: Operation

5.1 Interface description

Push up the air switch, after 5 seconds which enter into the user interface

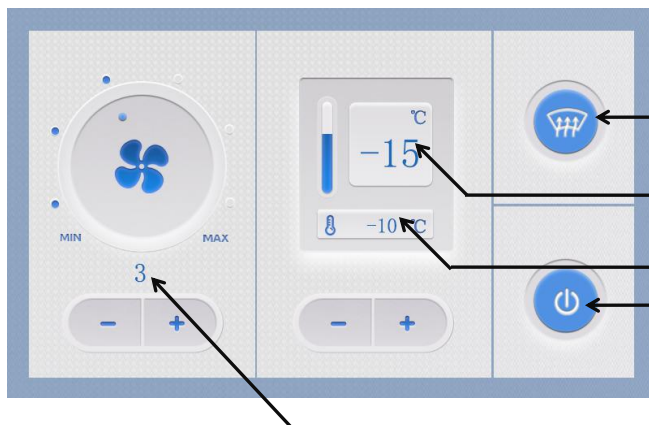

Defrost Button, 45s Automatic Defrost

Temperature Adjust, -20°C to -4°C

Actual temperature of cold box

Standby Button

Wind Speed Level 1-6

5.2 Quick Using

Machine cooling takes time, so the machine just blow out the wind temperature close to room temperature after a period of time (5 - 10 minutes) then the air will cooling. The machine needs to be

defrosted after two hours of operation. The machine tank stores the water produced by the defrost process, draining regularly after defrosting.

5.3 Machine Parameter

Type	air cooling system
Control System	5 Inch True Color Touch Screen
Power	1500W
Temperature	-20℃ to -4℃
Wind Lever	1-6 Adjustable
Defrost Time	45S
Working Voltage	110V, 60hz,3A, 220V,50hz, 3A
Net Weight	62kg
Cooling Tube Lengthe	2m
Supporter	3 part
Machine's Measure	810*400*845mm
Package Measure	915*515*1050mm

5.4 Operation

This machine can be used with 808 laser , IPL, 980 laser, CO2 laser, rf machine, Can reduce the pain and temperature, avoid the scald.

1、 Before treatment, can blow the treatment area for 2 minutes, cooling that

2、 The treatment head should target to the light outlet when you do the laser treatment.

3 , If there is no adapter with the optical device, then the face treatment, the outlet should be tilted along the patient's forehead to the direction of the chin for treatment, so that patients more comfortable.

Operation As Shown

Like this you should handle the outlet, and follow the treatment head when you operation.
Blowing while cooling.



If the operation uses the adapter head, the cold wind will blow out from the treatment head



If use of stents, while doing a cold side

